

**MOES**  
HOME SMART LIFE SERIES

Powered by **tuya**

# Instruction Manual LCD Smart Thermostatic Radiator Valve

English

WORKS WITH alexa WORKS WITH Google Assistant

WTRV-PJ-801-DD18

- Bitte scannen Sie den QR-Code, um das deutsche Handbuch, das Installationsvideo und die Funktionseinführung zu erhalten
- Escanee el código QR para obtener el manual en español, el video de instalación y la introducción de la función
- Veillez scanner le code QR pour obtenir le manuel en français, la vidéo d'installation et l'introduction des fonctions
- Отсканируйте QR-код, чтобы получить руководство на русском языке, видео по установке и описание функций
- Scansionare il codice QR per ottenere il manuale in italiano, il video di installazione e la guida alle funzionalità. Video di installazione e funzionalità
- Leia o código QR para obter o manual em português, o vídeo de instalação e a introdução das funções
- Zeskanuj kod QR, aby uzyskać instrukcje, filmy instalacyjne i funkcje
- من فضلك قم ب مسح رمز الاستجابة السريعة (QR-Code) للحصول على دليل المستخدم باللغة العربية وفيديو التثبيت ووصف الوظائف



请扫描二维码获取中文的说明书、安装视频及功能介绍

### Standard Accessories

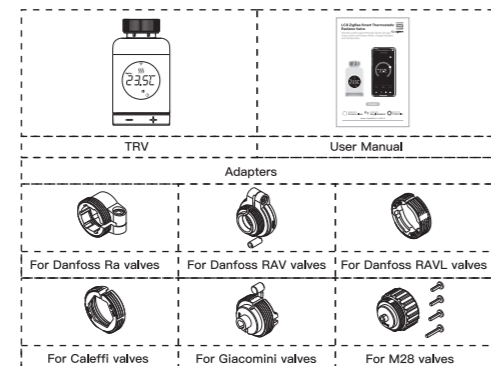

### Technical specifications

Power Supply:	3 x 1.5 V alkaline AA batteries (not included)
Standby Current:	6µA/Min
Protection Degree:	IP20
Operation Temperature:	0-50°C
Surface Temperature:	90°C Max (at the radiator)
Connection:	M30 x 1.5mm
Linear Travel:	6mm
Dimensions(W x H x D):	52.4mmx97.4mmx52.4mm
Net Weight:	150g
Frequency Wi-Fi:	2400-2483.5 MHz
RF power:	1.2dBm
Memory space:	8KB SRAM;1.5KB data flash;84KB code flash

### Display Symbols

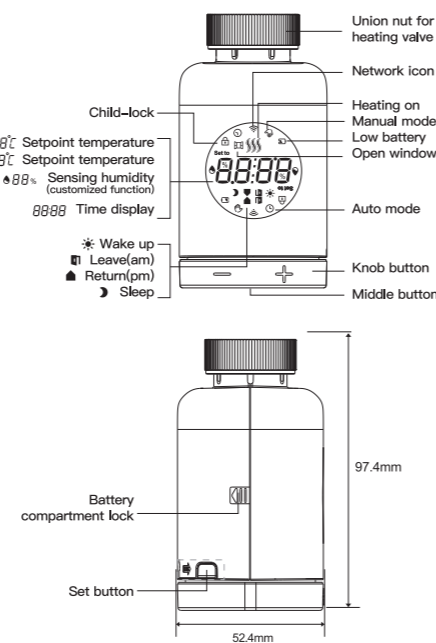

### Installation

- Press the battery compartment lock,remove the cover and insert the batteries;
  - Initialise, the mandrel retracts, then "175" is displayed on the scree.
  - When "175" stop blinking , install the M30\*1.5 threaded TRV connection nut for the heater valve and tighten the nut.
  - Press the "Middle button", "RAV" will flash and the device will start adjusting the valves.After a few seconds, the setup is complete when the initialisation screen appears.
- \*Attention:** While inserting the battery,please check that the battery polarity (+/-)is correctly aligned.
- Note:**The valve must be installed or an F5 error code will be displayed.

### Install the adapter correctly

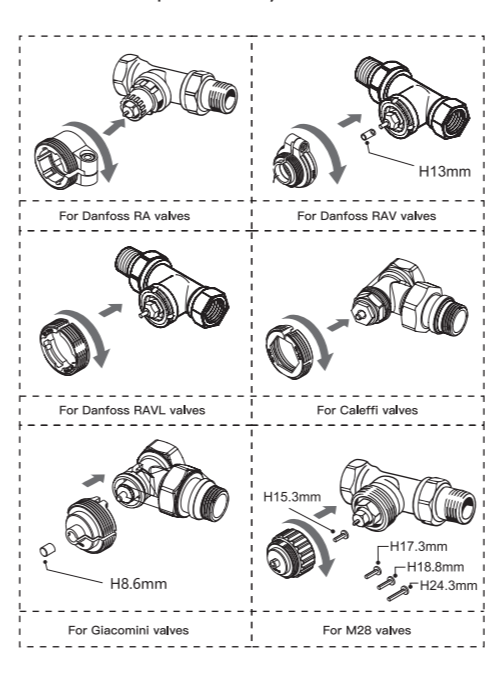

### Temperature control mode

- Temperature control mode**  
Press the "Middle button" briefly to switch between automatic mode "⊙" and manual mode "⊕".
- \*Attention:** Only Manual mode is available when the device is not connected to Internet.The device supports alternate display of set temperature and room temperature."Set" lights up showing the set temperature.
- Auto mode**  
When "⊙" is displayed on the screen, the unit is in auto mode. Four time periods and the temperature can be programmed per day, one week as a cycle, as required.
- Manual mode**  
When "⊕" is displayed on the screen, the appliance enters manual mode. The appliance operates according to the currently set temperature without being controlled by the time programme.
- Temporary mode**  
When you set the temperature in Auto mode,the unit enters temporary mode and "⊕⊕" appears on the screen. The unit is temporarily switched to manual mode without being controlled by the time programme.In the next time period,it returns to auto mode

### Heating pause mode

- ON:** In summer,when the heating system stops working,the valve can be fully opened by turning the knob clockwise to "ON" in manual mode.This will extend the life of the valve.
  - OFF:** In winter,in manual mode,turn the knob counter clockwise until "OFF" displays,then heating stops and frost protection is activated.
- \*Note:** After activating the frost protection function,the valve opens when the room temperature is below 5°C and it closes when the room temperature exceeds 7°C to prevent damage to the radiator thermostatic valve due to freezing.

### Setting the temperature and rotating the screen

- Set the temperature:** Turn the "Knob button" to set the temperature per step in 0.5°C.
  - Rotate the screen:** When the screen lights up, briefly press the "Set button" to change the direction of the screen display.
- Open window function**  
During heating,if the device detects that the room temperature has dropped by more than 1.5°C within 4.5 minutes,the open window function is activated and the device automatically stops heating.Once the function has been activated,the device will keep the valve closed for 30 minutes and the screen will display "⊠".
- \*Caution:** If the "Open window" function is activated, it is overridden by the following operations.  
① Temperature setting via the APP or the unit.  
② The detected temperature increases by more than 1.5°C with in 4.5 minutes.  
③ No operation of the APP or the unit within 30 minutes.

### Anti-scale and Child lock function

- Anti-scale:** TRV performs a routine descaling every DAY 1 (Monday) at 12:00 to protect the valve from calcification. During the descalcification "CAL" is displayed on the screen.
  - Child lock function:** Press and hold the "Middle button" for 3 seconds, then the screen will show "⊔" and the child lock is activated; In lock mode,press and hold the "Middle button" for 3 seconds,the screen "⊔" disappears, the child lock function is deactivated.
- Restoring the factory settings**  
Press and hold the "Middle button" while inserting the battery, until "FAC" is displayed on the screen and flashes for 3 seconds Then the unit will be reset to factory settings and reboot.
- \*Caution:** Once the unit has been reset to factory settings, all previous settings cannot be restored.

- Download the MOES APP**
- Download MOES App on App store or scan the QR code

MOES App is upgraded as much more compatibility than Tuya Smart/Smart Life App, functional well for scene controlled by Siri, widget and scene recommendations as the fully new customized service.  
**(Note:** Tuya Smart/Smart Life App still works, but MOES App is highly recommended)

- Registration or Log in.**  
- Download "MOES" Application.  
- Enter the Register/Login interface; tap "Register" to create an account by entering your phone number to get verification code and "Set password". Choose "Log In" if you already have a MOES account.

- Add device (only WIFI)**
- When the screen lights up, press and hold the "Set button" for 3 seconds until "⊕⊕" is blinking
- Enter the "Home" interface of the APP, click "⊕" in the upper right corner, select "Add Device", the system will automatically detect the device and click "Add"
- Open MOES App, then the prompt page will automatically show on the screen.Click "Add", Select the device you want to add and click "+".
- After the addition is successful,click "Done", and the WiFi smart thermostat has been added successfully.

**\*Attention:** Please turn on the Bluetooth of your phone in advance. And ensure that the smartphone OS allows the MOES APP to access the Bluetooth function.

- Add device (Only ZIGBEE)**
- When the screen lights up, press and hold the "Set button" for 3 seconds until "⊕⊕" is blinking.
- In the APP gateway interface select "zigbee device list", click "Add Device", wait for several seconds to search, the system will automatically search and add devices, and then click "Done".
- After the device is named, click "Done", the radiator thermostatic valve is added.

**\*Attention:** The gateway must be added before adding TRV. The TRV must be added in the page of gateway.

- Mode selection**
- System mode:** Tap "⊕" and enter the Advanced Setting page to change System mode.
- Energy-saving mode (factory setting):** Within the Temp.Dif. range,the device will automatically start or stop heating to avoid full-time heating.Save energy while taking comfort. (0.5 is the Min.Temp.Dif.value)
- Comfort mode:** Using PID control algorithm.The device constantly adjusts the valve to keep the temperature within a small range of the set temperature.The valve will not closed and the temperature will not fluctuate greatly. Greatly improve the comfort of use.
- Operating modes:** Tap "⊕" to select Operating Modes
- Auto mode:** Four time periods and setting temp. could be programmed per day, one week as a cycle based on customized needs.

**\*Attention:** The Comfort mode consumes more energy than the Energy-saving mode. Please select the system mode according to your needs.

- Manual mode:** The device will work according to current setting temp.without controlled by the time period program.
- OFF mode:** The valve will be closed to stop heating.
- ON mode:** The valve will open in heating.
- Weekly programming**  
① Click "⌚" to enter the Weekly programming page.  
② Set four time periods and setting temperature based on customized needs.
- Setting**  
Click "⊕" to enter the advanced setting page.

**\*Attention:** Click "+" or "-" to adjust the setting temperature.

- Statistics**  
Click "⊕" to enter the Temperature Statistics.
- Error code**  
Troubleshooting and maintenance

Error Code	Problem	Solution
F0	Temperature sensor abnormality	Contact after-sales staff
F1	Slow valve operation	Check the installation and heating valve
F2	The stroke is too long	Check the fastening of TRV
F3	The stroke is too short	Check the heating valve
F4	Running out of battery	Replace batteries immediately
F5	Valve not detected	To check if the valve is installed
Battery symbol (⊖)	Low battery	Replace batteries within 1 week

- Control your home with your voice**  
Devices are compatible with Amazon Alexa and Google Home supported functionalities. Please see our step-by-step guide on: <https://www.moestech.com/blogs/news/smart-device-linked-voice-speaker>
- SERVICE**  
Thank you for your trust and support to our products, we will provide you with a two-year worry-free after-sales service (freight is not included), please do not alter this warranty service card, to safeguard your legitimate rights and interests. If you need service or have any questions, please consult the distributor or contact us. Product quality problems occur within 24 months from the date of receipt, please prepare the product and the packaging, applying for after-sales maintenance in the site or store where you purchase; If the product is damaged due to personal reasons, a certain amount of maintenance fee shall be charged for repair. We have the right to refuse to provide warranty service if:  
1. Products with damaged appearance, missing LOGO or beyond the service term  
2. Products that are disassembled, injured, privately repaired, modified or have missing parts  
3. The circuit is burned or the data cable or power interface is damaged  
4. Products damaged by foreign matter intrusion (including but not limited to various forms of fluid, sand, dust, soot, etc.)

- RECYCLING INFORMATION**  
All products marked with the symbol for separate collection of waste electrical and electronic equipment (WEEE Directive 2012/19 / EU) must be disposed of separately from unsorted municipal waste. To protect your health and the environment, this equipment must be disposed of at designated collection points for electrical and electronic equipment designated by the government or local authorities. Correct disposal and recycling will help prevent potential negative consequences for the environment and human health. To find out where these collection points are and how they work, contact the installer or your local authority.
- Declaration of conformity**  
Hereby,WENZHOU NOVA NEW ENERGY CO.,LTD declares that the radio equipment type TRV-801 is in compliance with Directive 2014/53/EU. The full text of the EU declaration of conformity is available at the following internet address: <https://www.moestech.com/pages/ztrv-801>
- WARRANTY CARD**  
Product Information  
Product Name \_\_\_\_\_  
Product Type \_\_\_\_\_  
Purchase Date \_\_\_\_\_  
Warranty Period \_\_\_\_\_  
Dealer Information  
Customer's Name \_\_\_\_\_  
Customer Phone \_\_\_\_\_  
Customer Address \_\_\_\_\_

**Maintenance Records**

Failure date	Cause Of Issue	Fault Content	Principal

Thank you for your support and purchase at we Moes, we are always here for your complete satisfaction. Just feel free to share your great shopping experience with us.

★ ★ ★ ★ ★

**FOLLOW US**

f @moessmart MOES.Official  
X @moes\_smart @moes\_smart  
@moes\_smart www.moes.net

**UK REP** EVATOST CONSULTING LTD  
Address: Suite 11, First Floor, Moy Road, Business Centre, Taffs Well, Cardiff, Wales, CF15 7QR  
Tel: +44-292-1680945  
Email: contact@evatmaster.com

**EC REP** E-CrossStu-GmbH  
Mainzer Landstr. 69 ,60329 Frankfurt am Main  
Email: crosstu@web.de  
Tel: +496933296764  
Made In China

**Manufacturer:** WENZHOU NOVA NEW ENERGY CO.,LTD  
Address: Power Science and Technology Innovation Center, NO.238, Wei 11 Road, Yueqing Economic Development Zone, Yueqing, Zhejiang, China  
Tel: +86-577-57186815  
After-sale Service: service@moeshouse.com



### Installationshandbuch (Deutsch)

**Technische Spezifikationen**

Stromversorgung:	3 x 1,5 V alkaline AA batteries (nicht enthalten)
Standby-Strom:	6µA/min
Schutzgrad:	IP20
Betriebs-Temperatur:	0-50°C
Oberflächentemperatur:	90°C Max (am Kühler)
Verbindung:	M30 x 1.5mm
Lineare Bewegung:	6mm
Abmessungen (W x H x D):	52.4mmx97.4mmx52.4mm
Nettogewicht:	150g
Frequenz WLAN:	2400-2483.5 MHz
HF-Leistung:	12dBm
Speicherplatz:	8KB SRAM, 1.5KB data flash, 64KB code flash

**Installation**

- Drücken Sie die Batterieabdeckung, nehmen Sie den Deckel ab und legen Sie die Batterien ein.
- Initialisieren, der Dorn fährt zurück, dann wird "1755" auf dem Bildschirm angezeigt.
- Wenn "1755" aufhört zu blinken, installieren Sie die TRV-Verbindungsstücke mit M30\*1,5-Gewinde für das Heizungsventil und ziehen Sie die Mutter fest.
- Drücken Sie die "Middle button", "Auf" blinkt und das Gerät beginnt mit der Einstellung der Ventile. Nach einigen Sekunden ist die Einrichtung abgeschlossen, wenn der Initialisierungsbildschirm erscheint.

**Installieren Sie den Adapter korrekt**

- Für Danfoss RA-Ventile (H13mm)
- Für Danfoss RAV-Ventile (H15.3mm)
- Für Danfoss RAVL-Ventile (H15.3mm)
- Für Caleffi-Ventile (H17.3mm)
- Für H13mm (H13mm)
- Für H15.3mm (H15.3mm)
- Für H17.3mm (H17.3mm)
- Für H18.8mm (H18.8mm)
- Für H24.3mm (H24.3mm)
- Für H8.6mm (H8.6mm)
- Für M28-Ventile (H17.3mm)
- Für Giacomini-Ventile (H15.3mm)

**Laden Sie die MOES-APP herunter**

- Laden Sie die MOES-App im App Store herunter oder scannen Sie den QR-Code.
- Registrierung oder Einloggen.

**Gerät hinzufügen (nur WLAN)**

- Wenn der Bildschirm aufleuchtet, halten Sie die "Set button" 3 Sekunden lang gedrückt, bis "..." blinkt.
- Rufen Sie die "Home"-Oberfläche der APP auf, klicken Sie oben rechts auf "+" und wählen Sie "Add Device". Das System erkennt das Gerät automatisch und klickt auf "Add".

**Gerät hinzufügen (Nur ZIGBEE)**

- Wenn der Bildschirm aufleuchtet, halten Sie die "Set button" 3 Sekunden lang gedrückt, bis "..." blinkt.

**Fehlercode**

Fehlercode	Problem	Lösung
F0	Anomalie des Temperatursensors	Kontaktieren Sie den Kundendienst
F1	Lagerungs-Verschleiß	Überprüfen Sie die Installation und das Heizungsnetz
F2	Der Hub ist zu kurz	Überprüfen Sie die Befestigung des TRV
F3	Der Akku ist leer	Überprüfen Sie das Batterieniveau
F4	Ventil nicht erkannt	Überprüfen Sie die Batterien und ersetzen Sie sie, wenn sie leer sind
F5	Ventil nicht erkannt	Überprüfen Sie die Batterien und ersetzen Sie sie, wenn sie leer sind

**Steuern Sie Ihr Zuhause mit Ihrer Stimme**

Die Geräte sind mit den von Amazon Alexa und Google Home unterstützten Funktionen kompatibel. Bitte sehen Sie sich unsere Schritt-für-Schritt-Anleitung an: <https://www.moestech.com/blogs/news/smart-device-linked-voice-speaker>

**Declaration of conformity**

Hiemti erklart WENZHOU NOVA NEW ENERGY CO., LTD dass das Funkgerät Typ TRV-801 der Richtlinie 2014/53/EU entspricht. Der vollständige Text der EU-Konformitätserklärung ist unter folgender Internetadresse verfügbar: <https://www.moestech.com/pages/ztrv-801>

### Manual de instalación (Español)

**Especificaciones técnicas**

Fuente de alimentación:	3 x 1,5 V alkaline AA batteries (no incluidas)
Corriente de espera:	6µA/min
Grado de protección:	IP20
Temperatura de operación:	0-50°C
Temperatura de la superficie:	90°C Max (en el radiador)
Conexión:	M30 x 1.5mm
Viaje lineal:	6mm
Dimensiones (W x H x D):	52.4mmx97.4mmx52.4mm
Peso neto:	150g
Frecuencia Wi-Fi:	2400-2483.5 MHz
Potencia de RF:	12dBm
Espacio de memoria:	8KB SRAM, 1.5KB data flash, 64KB code flash

**Instalación**

- Presione el bloqueo del compartimento de las baterías, retire la tapa e inserte las baterías.
- Inicialice, el mandril se retrae y luego aparece "1755" en la pantalla.
- Cuando "1755" deje de parpadear, instale la tuerca de conexión TRV rosca M30\*1,5 para la válvula del calentador y apriete la tuerca.
- Presione el "Middle button", "Arriba" parpadeará y el dispositivo comenzará a ajustar los valores. Después de unos segundos, la configuración se completará cuando aparezca la pantalla de inicialización.

**Instale el adaptador correctamente**

- Para válvulas Danfoss RA (H13mm)
- Para válvulas Danfoss RAV (H15.3mm)
- Para válvulas Danfoss RAVL (H15.3mm)
- Para válvulas Caleffi (H17.3mm)
- Para H13mm (H13mm)
- Para H15.3mm (H15.3mm)
- Para H17.3mm (H17.3mm)
- Para H18.8mm (H18.8mm)
- Para H24.3mm (H24.3mm)
- Para H8.6mm (H8.6mm)
- Para válvulas M28 (H17.3mm)
- Para válvulas Giacomini (H15.3mm)

**Descarga la APLICACIÓN MOES**

- Descargue la aplicación MOES en la tienda de aplicaciones o escanee el código QR.
- Regístrate o inicia sesión.

**Añadir dispositivo (solo WiFi)**

- Cuando la pantalla se ilumine, mantenga presionado el "Set button" durante 3 segundos hasta que "..." parpadee.
- Ingrese a la interfaz "Home" de la APLICACIÓN, haga clic en "+" en la esquina superior derecha, seleccione "Add Device". El sistema detectará automáticamente el dispositivo y hará clic en "Add".

**Código de error**

Código de error	Problema	Solución
F0	Anomalía del sensor de temperatura	Contactar con el personal de soporte
F1	Operación lenta de la válvula	Comprobar la instalación y la calidad de la calefacción
F2	El trazo es demasiado corto	Comprobar el funcionamiento del TRV
F3	El trazo es demasiado corto	Comprobar la calidad de la calefacción
F4	El trazo es demasiado corto	Reemplazar las baterías inmediatamente
F5	Válvula no detectada	Para comprobar si la válvula está instalada correctamente

**Controla tu hogar con tu voz**

Los dispositivos son compatibles con las funcionalidades compatibles con Amazon Alexa y Google Home. Consulte nuestra guía paso a paso sobre: <https://www.moestech.com/blogs/news/smart-device-linked-voice-speaker>

**Declaración de conformidad**

Por la presente, WENZHOU NOVA NEW ENERGY CO., LTD declara que el equipo de radio tipo TRV-801 cumple con la Directiva 2014/53/UE. El texto completo de la declaración UE de conformidad está disponible en la siguiente dirección de Internet: <https://www.moestech.com/pages/ztrv-801>

### Manuale di installazione (Italiano)

**Specifiche tecniche**

Fonte di alimentazione:	3 x 1,5 V alkaline AA batteries (non incluse)
Corrente in standby:	6µA/min
Grado di protezione:	IP20
Temperatura di funzionamento:	0-50°C
Temperatura superficiale:	90°C Max (al radiatore)
Connessione:	M30 x 1.5mm
Viaggio lineare:	6mm
Dimensioni (W x H x D):	52.4mmx97.4mmx52.4mm
Peso netto:	150g
Frequenza Wi-Fi:	2400-2483.5 MHz
Potenza RF:	12dBm
Spazio di memoria:	8KB SRAM, 1.5KB data flash, 64KB code flash

**Installazione**

- Premere il blocco del vano batterie, rimuovere il coperchio e inserire le batterie.
- Initializzare, il mandrino si ritira, quindi sullo schermo TRV fletto viene visualizzato "1755".
- Quando "1755" smette di lampeggiare, installare il dado di collegamento TRV filetato M30\*1,5 per la valvola del riscaldatore e serrare il dado.
- Premere il "Middle button", "Arriba" lampeggerà e il dispositivo inizierà a regolare le valvole. Dopo alcuni secondi, la configurazione sarà completa quando verrà visualizzata la schermata di inizializzazione.

**Installare l'adattatore correttamente**

- Per valvole Danfoss RA (H13mm)
- Per valvole Danfoss RAV (H15.3mm)
- Per valvole Danfoss RAVL (H15.3mm)
- Per valvole Caleffi (H17.3mm)
- Per H13mm (H13mm)
- Per H15.3mm (H15.3mm)
- Per H17.3mm (H17.3mm)
- Per H18.8mm (H18.8mm)
- Per H24.3mm (H24.3mm)
- Per H8.6mm (H8.6mm)
- Per valvole M28 (H17.3mm)
- Per valvole Giacomini (H15.3mm)

**Scarica l'APP MOES**

- Scarica l'app MOES sull'App Store o scansiona il codice QR.
- Registrazione o Accedi.

**Aggiungi dispositivo (solo Wi-Fi)**

- Quando lo schermo si illumina, tenere premuto il "Set button" per 3 secondi finché "..." non lampeggia.
- Accedere all'interfaccia "Home" dell'APP, fare clic su "+" nell'angolo in alto a destra, selezionare "Add Device". Il sistema rileverà automaticamente il dispositivo e farà clic su "Add".

**Codice di errore**

Codice di errore	Problema	Soluzione
F0	Anomalia del sensore di temperatura	Rivolgersi al personale post-vendita
F1	Funzionamento lento della valvola	Controllare l'installazione e la qualità del riscaldamento
F2	La corsa è troppo breve	Controllare il viaggio del TRV
F3	La corsa è troppo breve	Controllare la qualità del riscaldamento
F4	Batteria scarica	Sostituire immediatamente le batterie
F5	Válvula non rilevata	Per verificare se la valvola è installata correttamente

**Controlla la tua casa con la tua voce**

I dispositivi sono compatibili con le funzionalità supportate da Amazon Alexa e Google Home. Consulta la nostra guida passo passo su: <https://www.moestech.com/blogs/news/smart-device-linked-voice-speaker>

**Dichiarazione di conformità**

Con la presente, WENZHOU NOVA NEW ENERGY CO., LTD dichiara che l'apparecchiatura radio tipo TRV-801 è conforme alla Direttiva 2014/53/UE. Il testo completo della dichiarazione di conformità UE è disponibile al seguente indirizzo internet: <https://www.moestech.com/pages/ztrv-801>

### Manual de instruções (Português)

**Especificações técnicas**

Fonte de energia:	3 x 1,5 V alkaline AA batteries (não incluídas)
Corrente de espera:	6µA/min
Grau de proteção:	IP20
Temperatura de operação:	0-50°C
Temperatura da superfície:	90°C Max (no radiador)
Conexão:	M30 x 1.5mm
Viagem Linear:	6mm
Dimensões (W x H x D):	52.4mmx97.4mmx52.4mm
Peso líquido:	150g
Frequência Wi-Fi:	2400-2483.5 MHz
Potência de RF:	12dBm
Espaço de memória:	8KB SRAM, 1.5KB data flash, 64KB code flash

**Instalação**

- Pressione a trava do compartimento das baterias, remova a tampa e insira as baterias.
- Inicialize, o mandril retrai e "1755" é exibido na tela.
- Quando "1755" parar de piscar, instale a porca de conexão TRV rosca M30\*1,5 para a válvula do aquecedor e aperte a porca.
- Pressione o "Middle button", "Arriba" piscará e o dispositivo começará a ajustar as válvulas. Após alguns segundos, a configuração estará concluída quando a tela de inicialização aparecer.

**Instale o adaptador corretamente**

- Para válvulas Danfoss RA (H13mm)
- Para válvulas Danfoss RAV (H15.3mm)
- Para válvulas Danfoss RAVL (H15.3mm)
- Para válvulas Caleffi (H17.3mm)
- Para H13mm (H13mm)
- Para H15.3mm (H15.3mm)
- Para H17.3mm (H17.3mm)
- Para H18.8mm (H18.8mm)
- Para H24.3mm (H24.3mm)
- Para H8.6mm (H8.6mm)
- Para válvulas M28 (H17.3mm)
- Para válvulas Giacomini (H15.3mm)

**Baixar o APP MOES**

- Baixar o aplicativo MOES na App Store ou escaneie o código QR.
- Cadastre-se ou faça login.

**Adicionar Dispositivo (apenas Wi-Fi)**

- Quando a tela acender, pressione e segure o "botão Set" por 3 segundos até que "..." esteja piscando.
- Entre na interface "Home" do APP, clique em "+" no canto superior direito, selecione "Add Device". O sistema detectará automaticamente o dispositivo e clicará em "Add".

**Erro de código**

Erro de código	Problema	Solução
F0	Anomalia do sensor de temperatura	Entre em contato com o equipe de pós-venda
F1	Operação lenta da válvula	Verifique a instalação e o equipamento de aquecimento
F2	O curso é muito curto	Verifique o curso do TRV
F3	O curso é muito curto	Verifique a qualidade do aquecimento
F4	Bateria sem energia	Substitua as baterias imediatamente
F5	Válvula não detectada	Para verificar se a válvula está instalada corretamente

**Controle sua casa com sua voz**

Os dispositivos são compatíveis com as funcionalidades suportadas da Amazon Alexa e do Google Home. Consulte nossa guia passo a passo sobre: <https://www.moestech.com/blogs/news/smart-device-linked-voice-speaker>

**Declaração de conformidade**

Por meio desta, WENZHOU NOVA NEW ENERGY CO., LTD declara que o equipamento de rádio tipo TRV-801 está em conformidade com a Diretiva 2014/53/UE. O texto integral da declaração UE de conformidade está disponível no seguinte endereço Internet: <https://www.moestech.com/pages/ztrv-801>